



DEPARTMENT OF HEALTH & FAMILY WELFARE
GOVERNMENT OF ODISHA

Request for Proposal for Operation, Maintenance and
Management of Cardiac Centre in Jharsuguda on PPP mode

Ref No. ME-II-M-7/14(24)
2699

Addendum – 2

Dated: 5th February 2016

Reference: RFP issued by this office of undersigned vide notification No. ME-II-M 7/14
Pt. dated 15.12.2015

Sl. No.	Reference Clause/Schedule	Particulars of Amendment																		
1.	Schedule A: Project Site of Draft Concession Agreement of RFP Document	The Project Site map provided under Schedule A of Draft Concession Agreement is revised as per the Annexure attached to this Addendum.																		
2.	Schedule B: List of Medical Equipment and Furniture of Draft Concession Agreement of RFP document	Rooms & Wards: <u>Hospital Beds with break up:</u> <table border="1"><thead><tr><th>Category</th><th>No. of beds</th></tr></thead><tbody><tr><td>Intensive Care Unit (ICU)</td><td>12</td></tr><tr><td>Postoperative Care</td><td>3</td></tr><tr><td>General</td><td>18</td></tr><tr><td>Twin Sharing</td><td>8</td></tr><tr><td>Single</td><td>5</td></tr><tr><td>Deluxe</td><td>1</td></tr><tr><td>Casualty</td><td>3</td></tr><tr><td>Total</td><td>50</td></tr></tbody></table>	Category	No. of beds	Intensive Care Unit (ICU)	12	Postoperative Care	3	General	18	Twin Sharing	8	Single	5	Deluxe	1	Casualty	3	Total	50
Category	No. of beds																			
Intensive Care Unit (ICU)	12																			
Postoperative Care	3																			
General	18																			
Twin Sharing	8																			
Single	5																			
Deluxe	1																			
Casualty	3																			
Total	50																			

Joint Secretary

Department of Health & Family Welfare

Muzra. Tharavudha Town Unit no-08 Mainvada



ନିମ୍ନ- ବିଭାଗର ଚିତ୍ରଣ ଉପରେ ମାଧ୍ୟମରେ

ଆକାଶ ? ବିଭାଗର

ବି - ବିଭାଗର

ଠିକଣା - P 5" = P ମାଧ୍ୟମ

Police - Tharavudha Station

Dist. Tharavudha

Scale - 1/6" = 1 mile

(ଖୋଲି କୋଣରୁ ନିର୍ଦ୍ଦିଷ୍ଟ ଭାଗ ଦେଖି ଥିଲେ)

Remained part on the major settlement map

From

Khatra No	୧୧୧	Plet No	୨	Area	୨୩୫	କିମି	Kiram
୨୧୬	୮୩	୨୩୨	୨	୪୫.୦୫	୩୫୫	୩୫୫	Patita
୩୬୮	୨୧୬	୩୦୨୫	୩୦୨୮	୩୫୫	୩୫୫	୩୫୫	

(ସ୍ୱାସ୍ଥ୍ୟ ଓ ପରିବାର କଲେଜ ବିଭାଗ, ଓଡ଼ିଶା ସରକାର)

Health and Family Welfare Dept. Govt of Odisha

[Signature]

[Signature]

COLLECTOR
THARAVUDHA

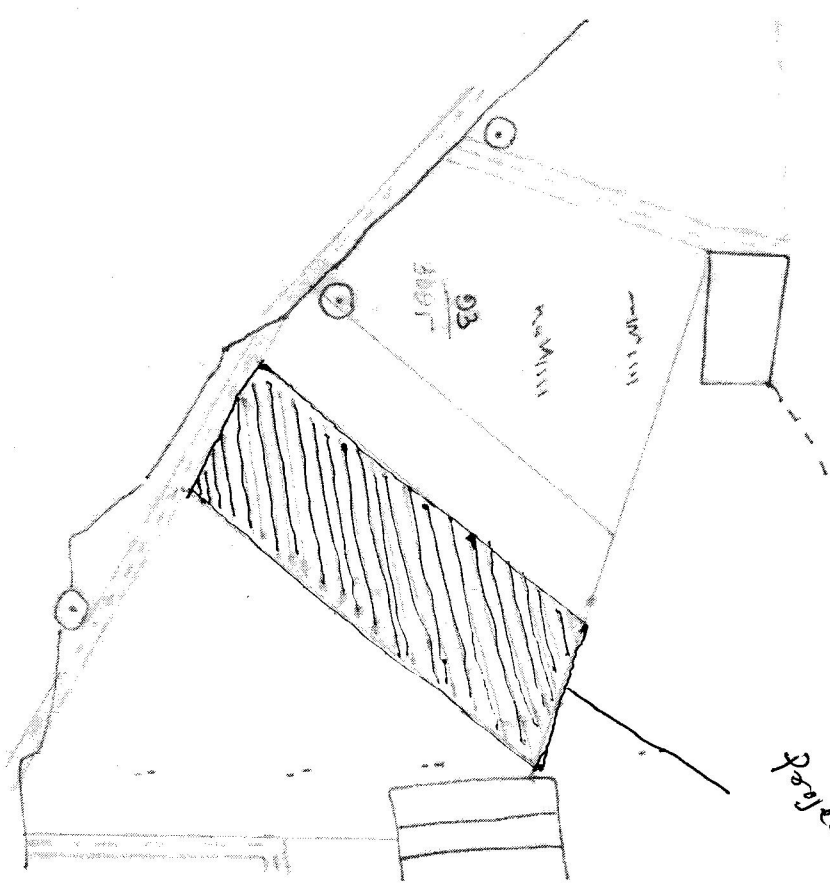

Project Site

Chief Executive Officer
Tharavudha
27.1.16